

PAC 固定夾具

專用於固定 DFSU, AL-20, 21 系列感應開關於拉桿缸



PAC

材質：鋅合金

注意!

請勿用過大的扭力鎖緊，有可能導致感應開關或氣缸損壞。

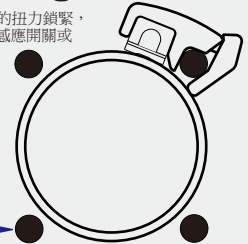
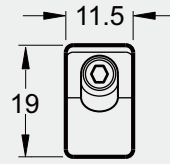
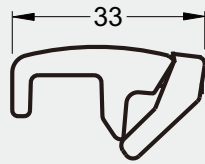

拉桿直徑

適用於：32 ϕ 至 125 ϕ 拉桿缸（拉桿直徑尺寸從 5 ϕ 至 12 ϕ ）

PM 固定夾具

專用於固定 DFSU, AL-20, 21 系列感應開關於拉桿缸



PM - 6

PM - 8

PM - 10

PM - 12

PM - 16

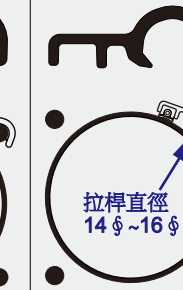
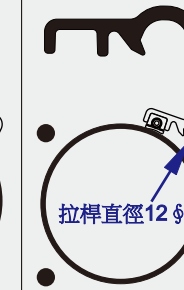
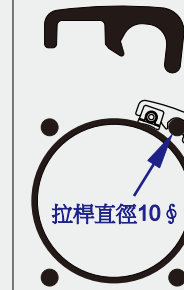
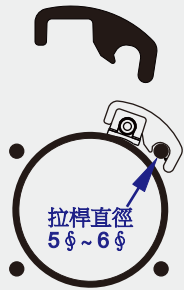

拉桿直徑 5 ϕ ~ 6 ϕ

拉桿直徑 8 ϕ

拉桿直徑 10 ϕ

拉桿直徑 12 ϕ

拉桿直徑 14 ϕ ~ 16 ϕ

PI 固定夾具

專用於固定 DFSU, AL-20, 21 系列感應開關於 ISO 米型缸

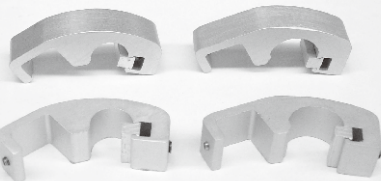

PI-1

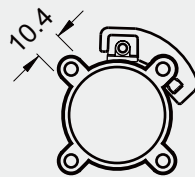
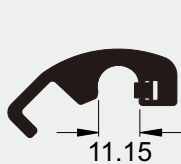

PI-1 適用於 32 ϕ 與 40 ϕ 的氣缸

PI-2

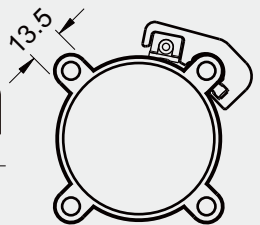
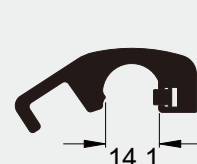

PI-2 適用於 50 ϕ 與 63 ϕ 的氣缸

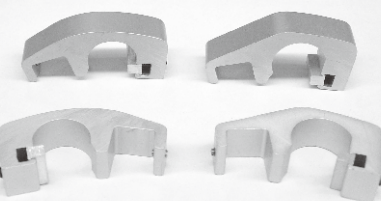

PI-3

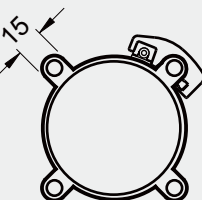

PI-3 適用於 80 ϕ 的氣缸

PI-4

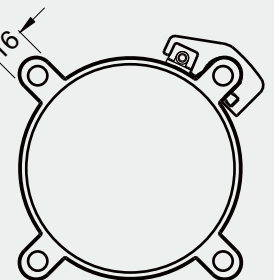
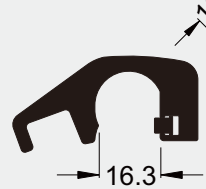

PI-4 適用於 100 ϕ 的氣缸